

## Type No. 421-101-012



MEGA-Line  
RACING ELECTRONIC GmbH  
Haunersdorfer Str.3  
D - 93342 Saal a.d. Donau

Germany

Phone: +49 (0) 9441 6866 - 0  
Fax: +49 (0) 9441 6866 - 11

Mail: [info@mega-line.com](mailto:info@mega-line.com)  
Web: [www.mega-line.com](http://www.mega-line.com)

### Description / features

The external clutch dis-engagement system is a pneumatic application which is used to create the possibility to open the clutch externally, i.e. without pressing the clutch paddle of the car. The unit fulfills the requirements of the governing bodies for external clutch dis-engagement, intending to be able to move the car in case of an incident.

The unit is supplied with pressurized air of 6 to 8 bar. For standard clutch pressures the system, utilized in combination with e.g. a MEGA-Line Compressor GT  $\mu$ C, does not require any additional pressure reservoir.

The unit has to be activated by a switch which keeps the valve activated.

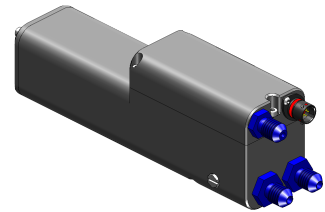

### Technical specifications

#### Electronic data:

Operating voltage	13.5 V nom.
Operating current (per activated valve)	approx. 200 mA

#### Mechanical data:

Dimensions L x W x H	approx. 201.4 x 46 x 64.5 mm
Weight	approx. 795 g
Fitting for air pressure inlet	Dash4
Fitting for hydraulic pressure inlet/outlet	Dash4

#### Pneumatic data:

Max. operating pressure	6 - 8 bar
-------------------------	-----------

#### Hydraulic data:

Max. operating pressure	80 bar
-------------------------	--------

#### Connector:

Deutsch 5 pin	ASL006-05PN
---------------	-------------

#### Temperature range:

Ambient (min/max)	0 .. +70°C
-------------------	------------

#### Ordering information:

Article no.	421-101-012
Order no.	11375

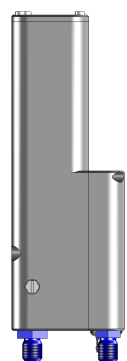

Type No. 421-101-012

## Pin assignment (electric)

Pin	Function	Dia [AWG]	Type
1	+12V	22	pwr
2	nc	/	nc
3	GND	22	pwr
4	nc	/	nc
5	nc	/	nc

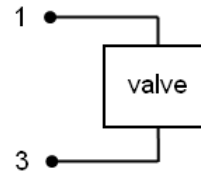

## Port description (hydraulic & pneumatic)

Port	Function	Dimension	max.torque [Ncm]
1	Air pressure inlet	Dash4	800
2	Hydraulic pressure outlet	Dash4	800
3	Hydraulic pressure inlet	Dash4	800

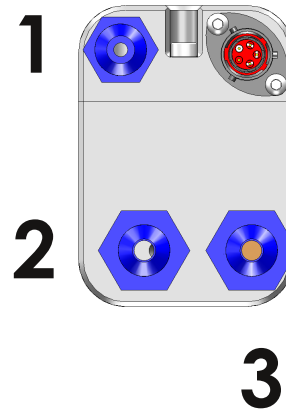

## Attention!



Both pressure balance orifice must not be covered or restricted in any way!

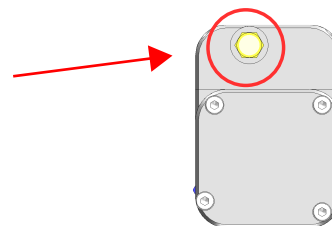

Type No. 421-101-012

MEGA-Line  
RACING ELECTRONIC GmbH  
Haunersdorfer Str.3  
D - 93342 Saal a.d. Donau

Germany

Phone: +49 (0) 9441 6866 - 0  
Fax: +49 (0) 9441 6866 - 11

Mail: info@mega-line.com  
Web: www.mega-line.com

## Assembly dimensions

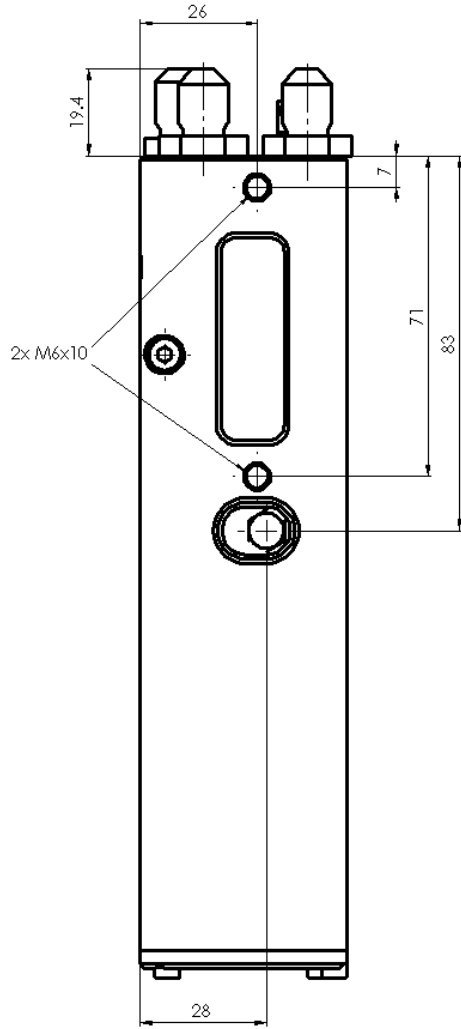

front view

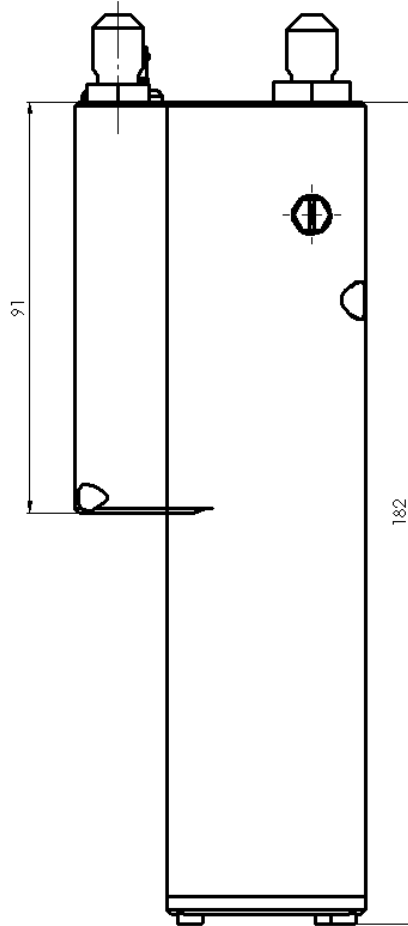

side left view

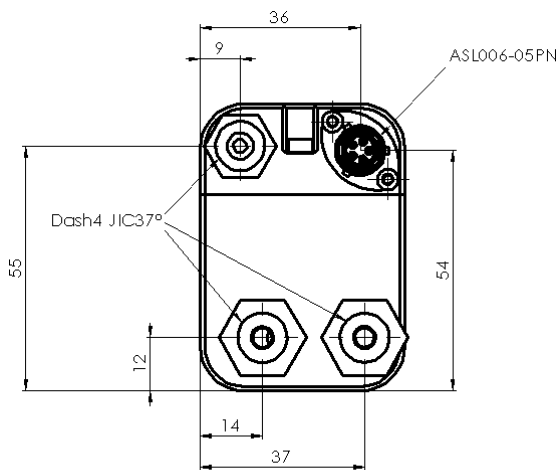

top view

# EXTERNAL CLUTCH DIS-ENGAGEMENT SYSTEM

Type No. 421-101-012



MEGA-Line  
RACING ELECTRONIC GmbH  
Haunersdorfer Str.3  
D - 93342 Saal a.d. Donau

Germany

Phone: +49 (0) 9441 6866 - 0  
Fax: +49 (0) 9441 6866 - 11

Mail: [info@mega-line.com](mailto:info@mega-line.com)  
Web: [www.mega-line.com](http://www.mega-line.com)

## Mechanical dimensions

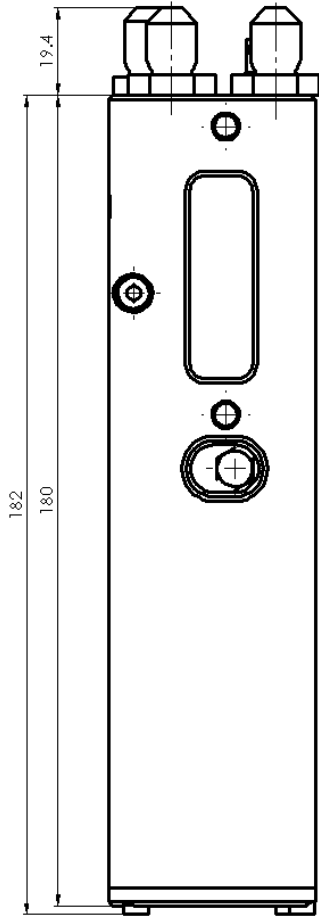

front view

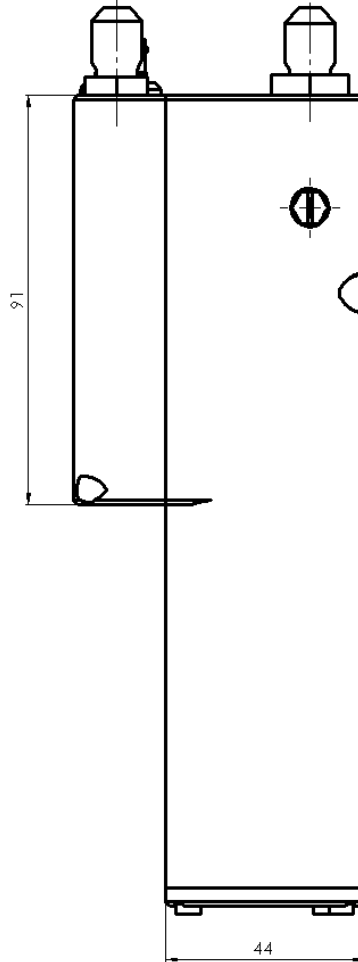

side left view

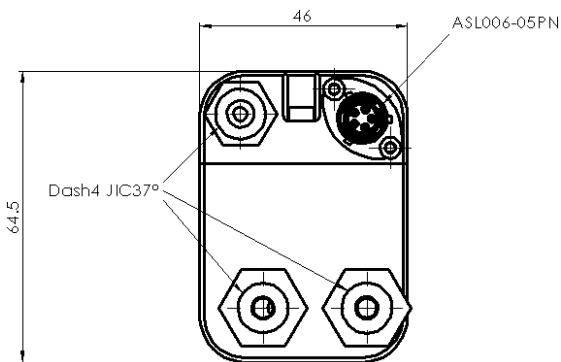

top view